

LM-5 (Apollo 11) and the hatch for LM-6 (Apollo12)

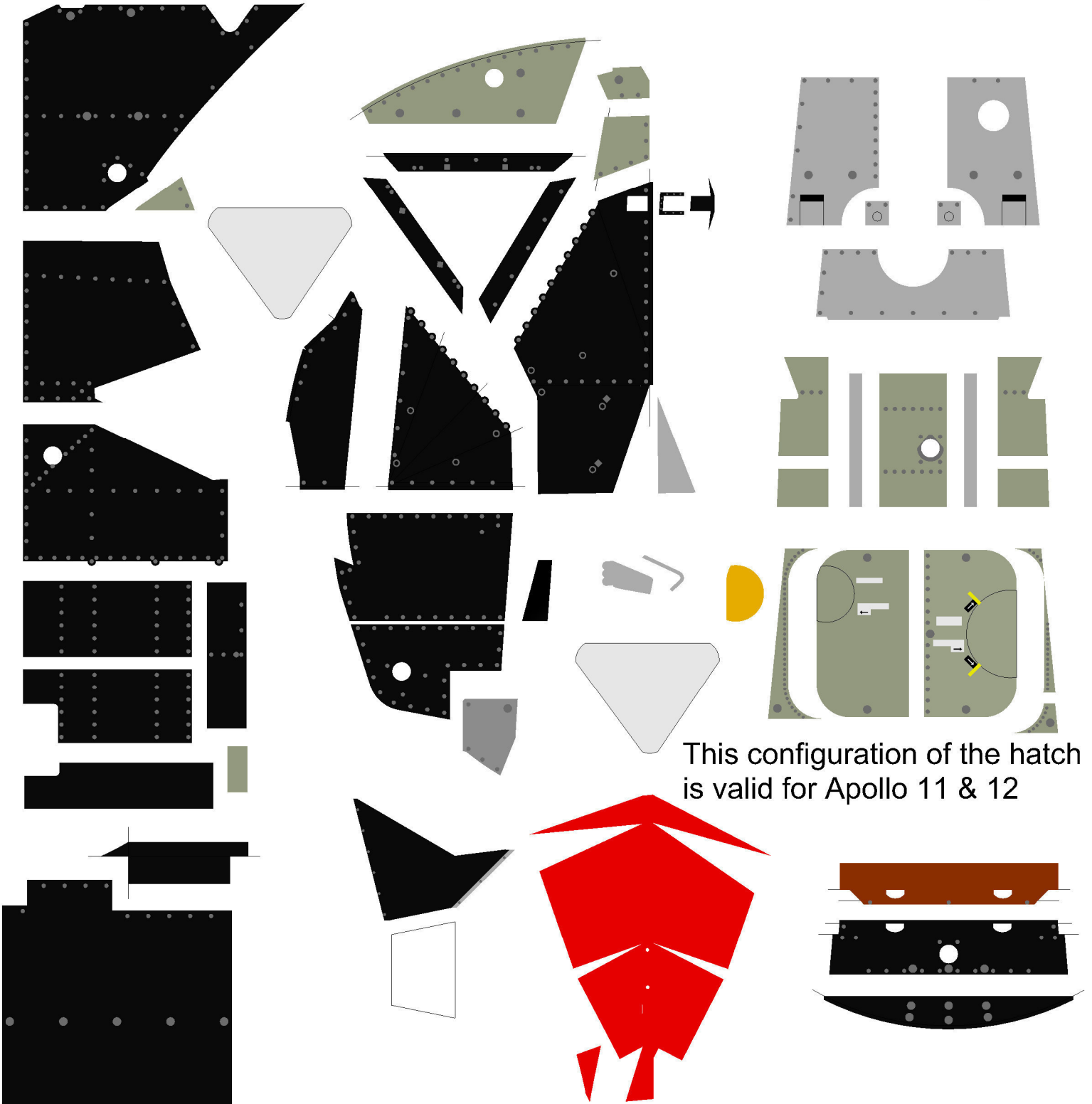

This configuration of the hatch
is valid for Apollo 11 & 12

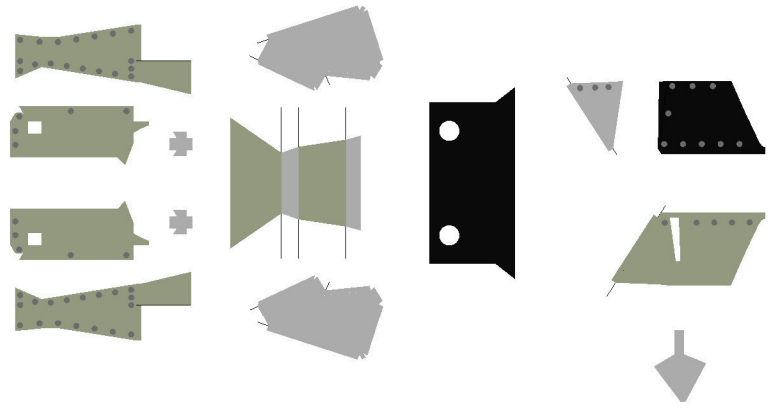

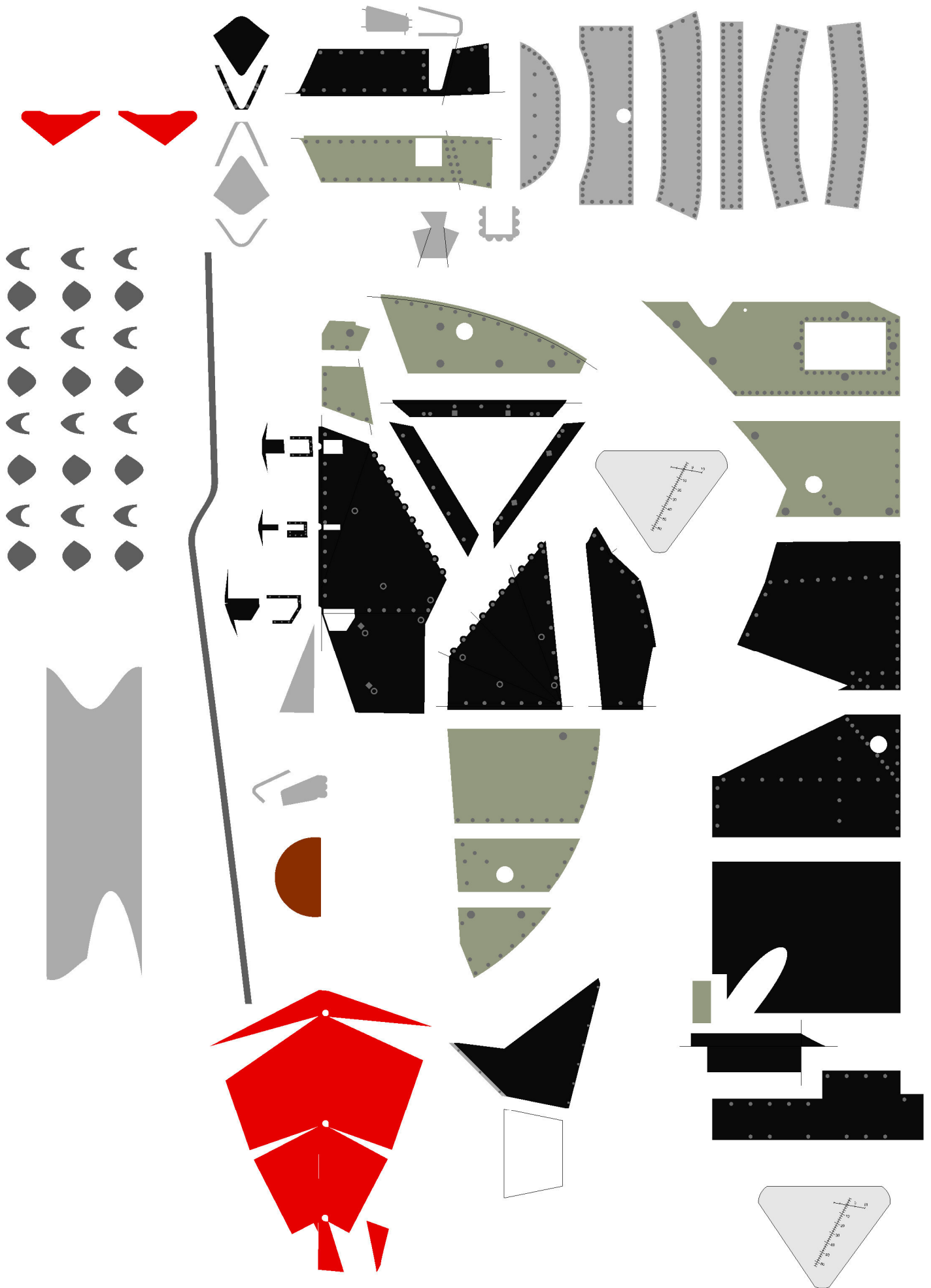
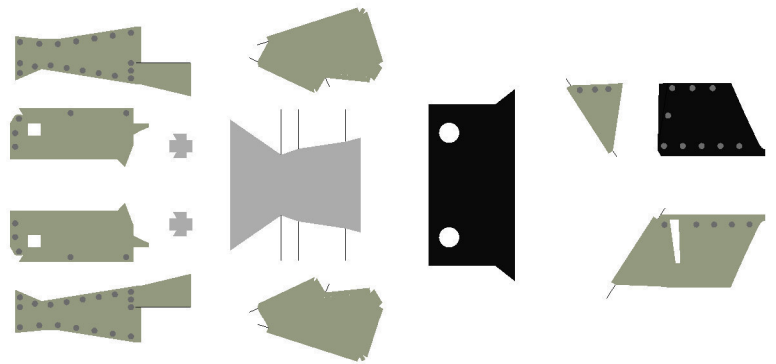
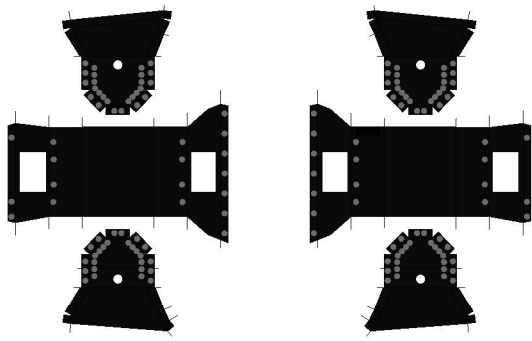

LM-6 to 12 (Apollo 12 to 17)

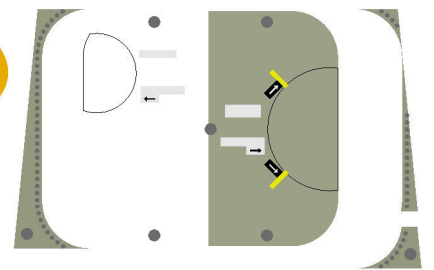
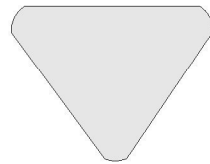
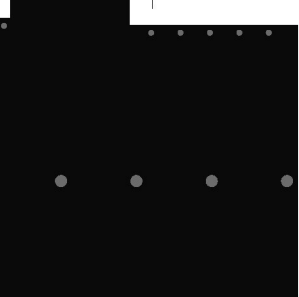
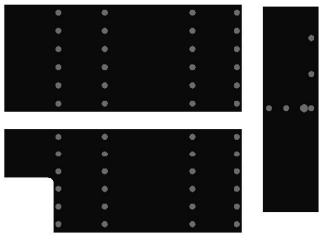
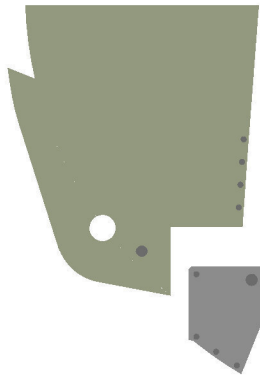
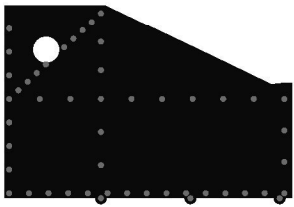
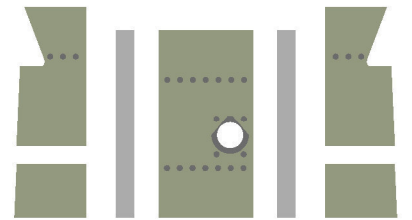
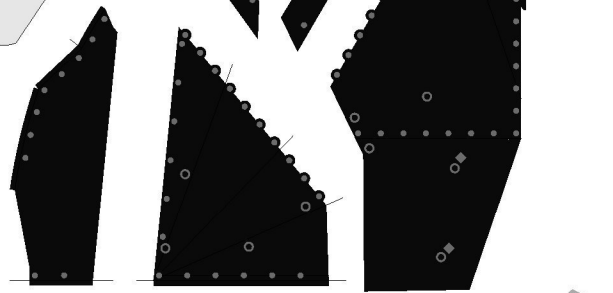
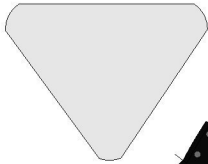
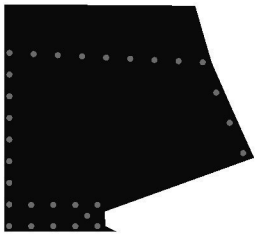
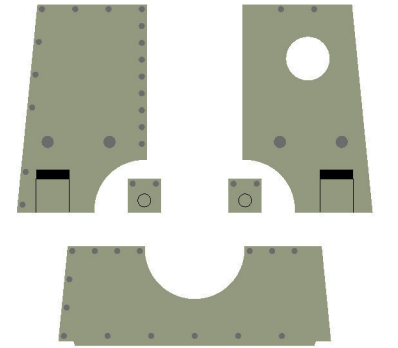
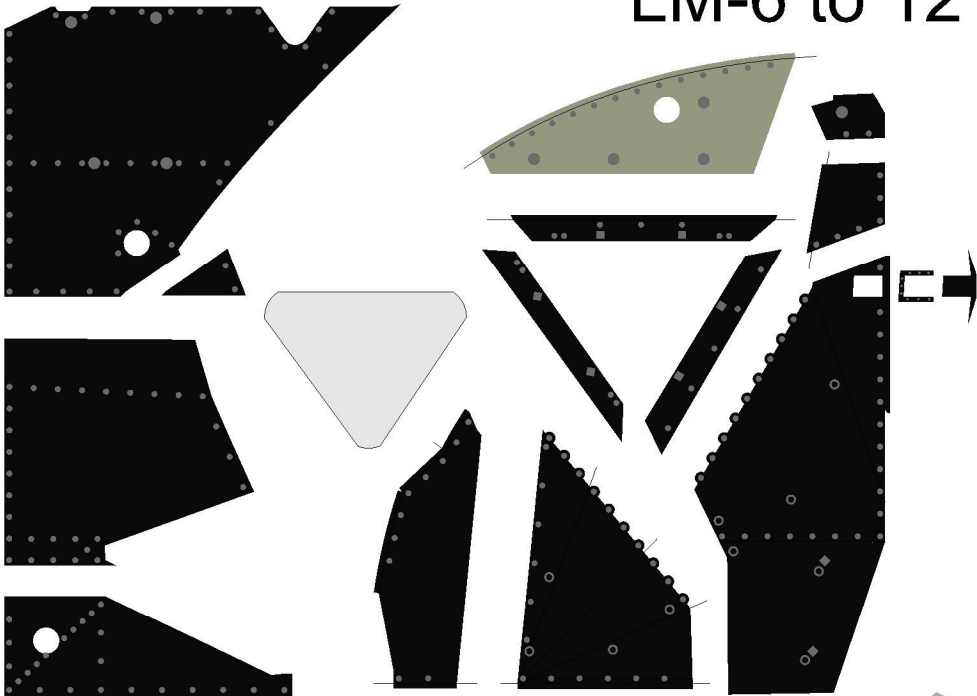

This configuration of the hat
is not valid for Apollo 12

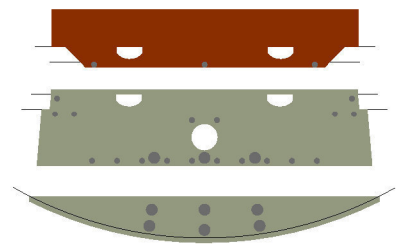
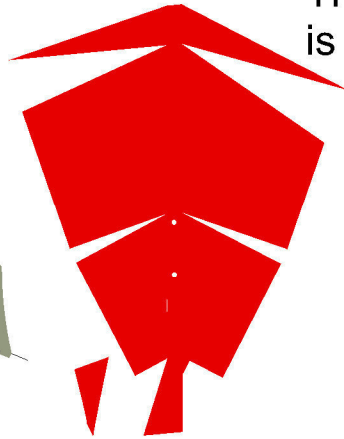
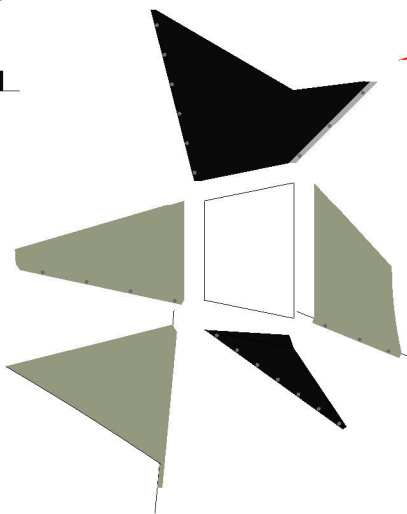

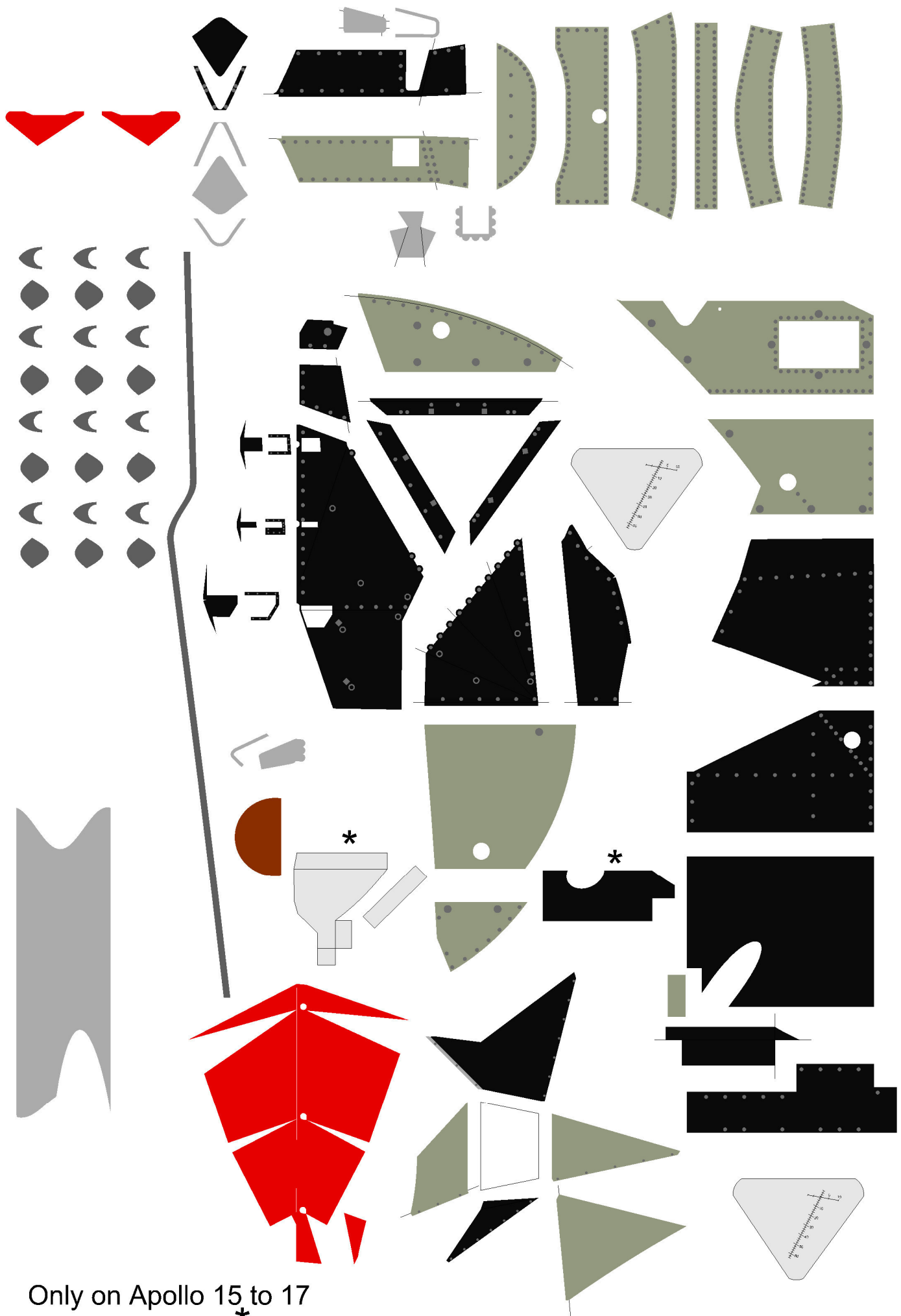

Only on Apollo 15 to 17
*

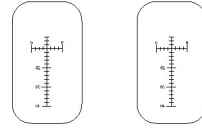
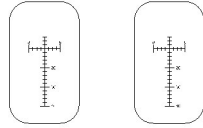
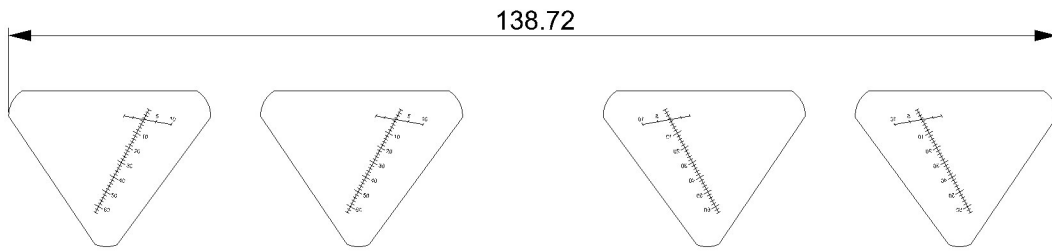

Decal for the outside window

Decal for the inside window